



Quick Installation User Guide

Standard Package



Appearance

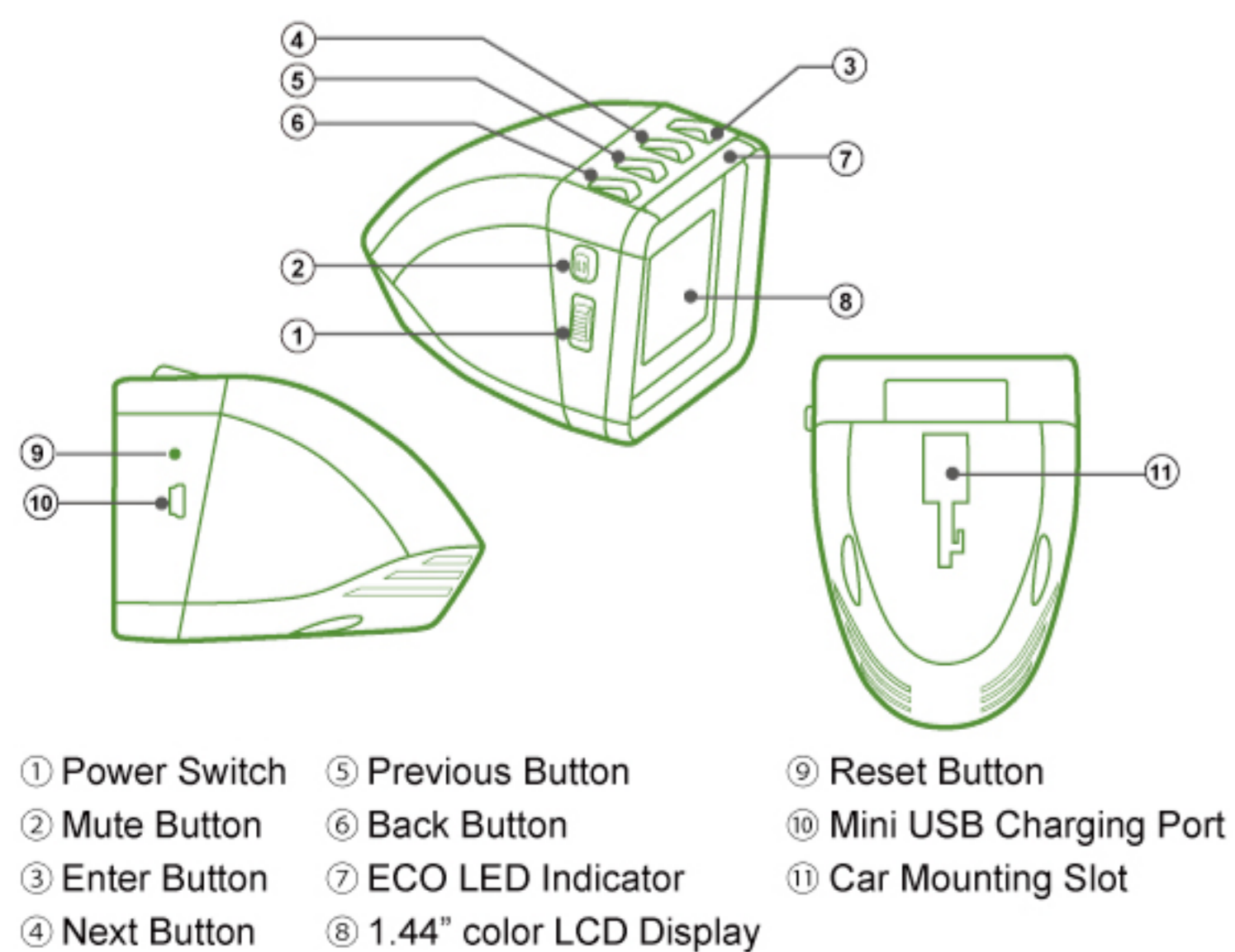

Step 1: Firstly fix attached anti-slip sticky pad to the flat surface of your vehicle's dashboard.

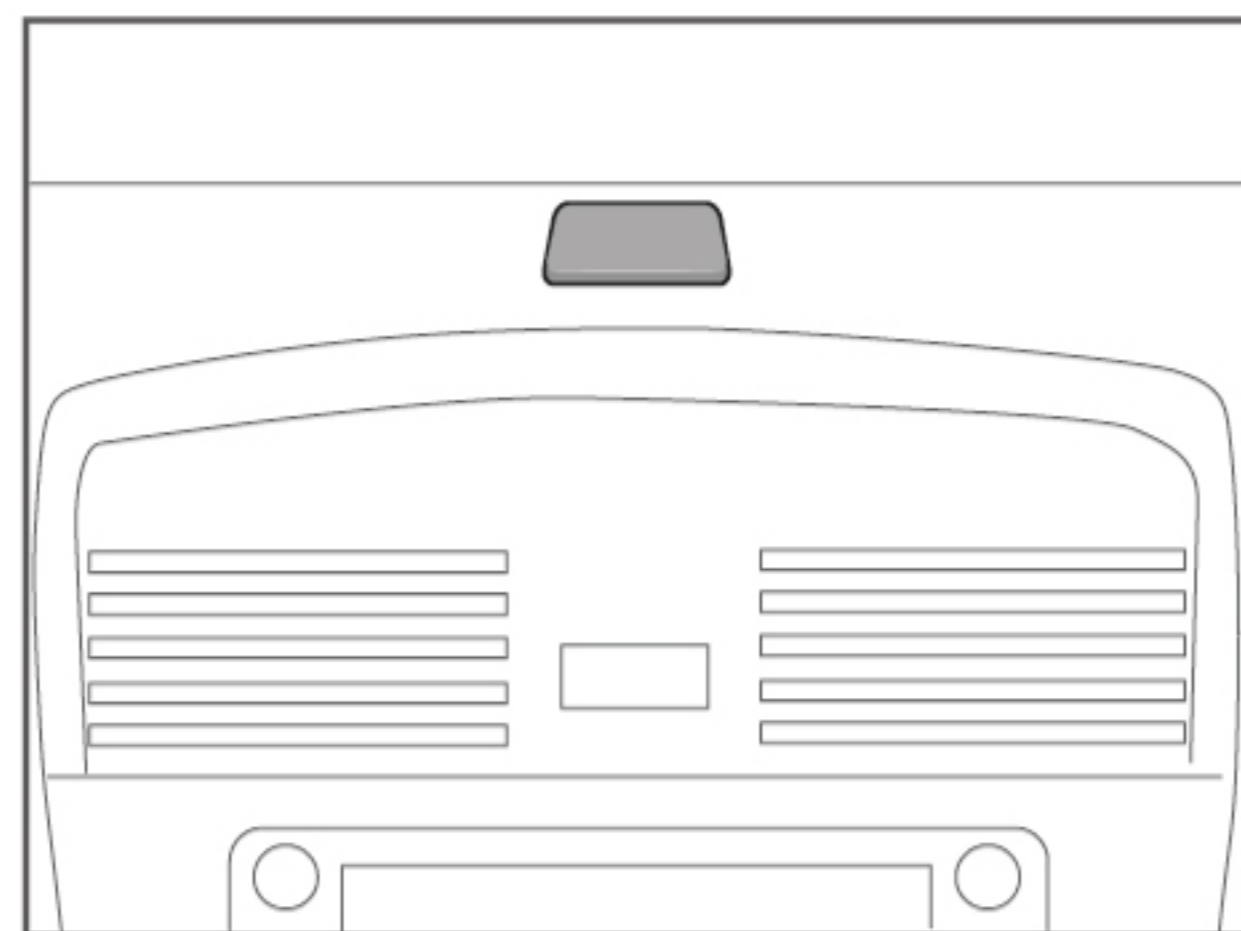

Step 2: Fix ECO STAR on the anti-slip sticky pad.
Please note to fix ECO STAR in parallel with the dashboard, ECO STAR logo face up to the sky for precisely detect your driving behavior.

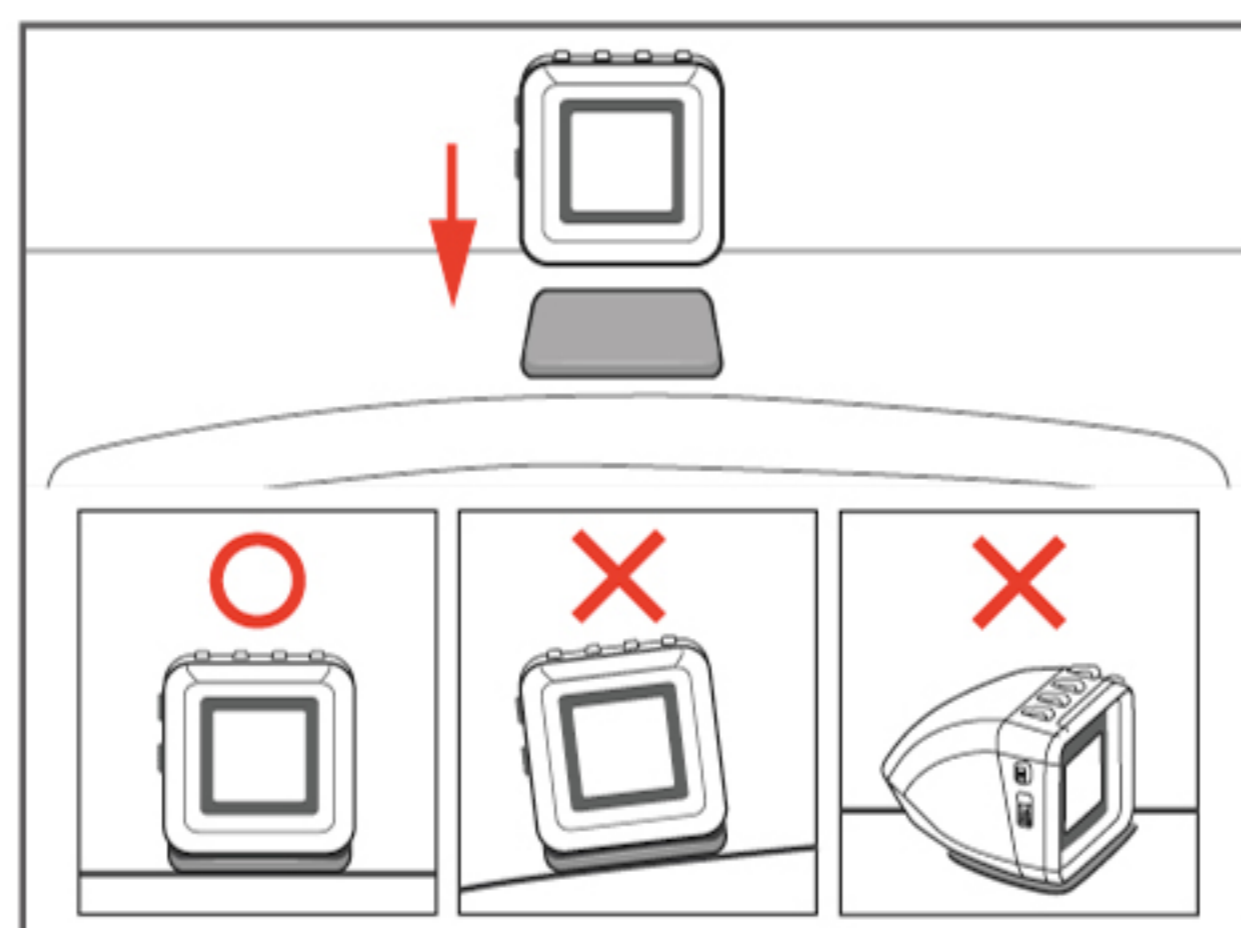

Step 3: Plug one end of car charger into cigarette lighter socket of vehicle, and plug the other end into ECO STAR's USB socket.

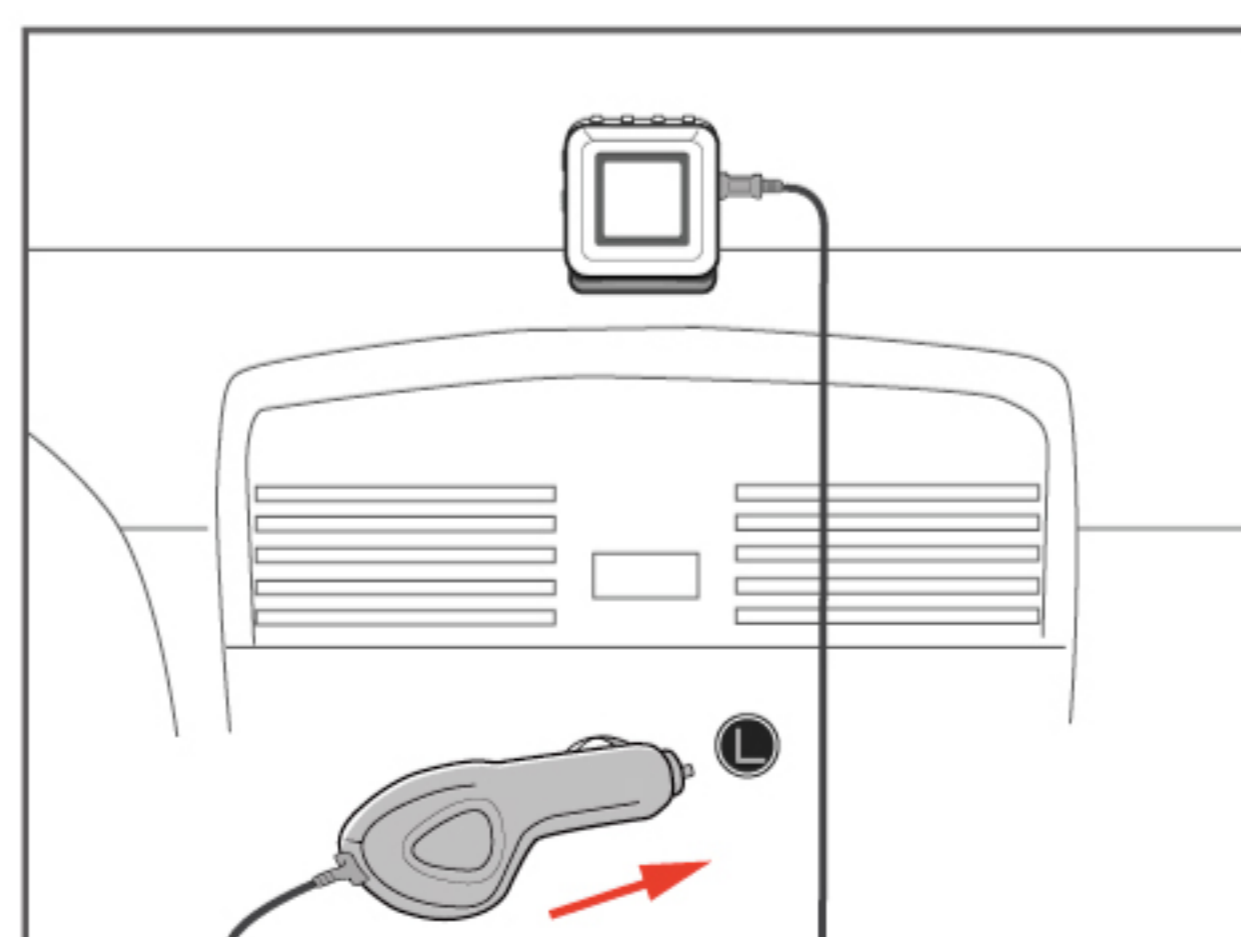

Step 4: Switch on ECO STAR by switching to On status.

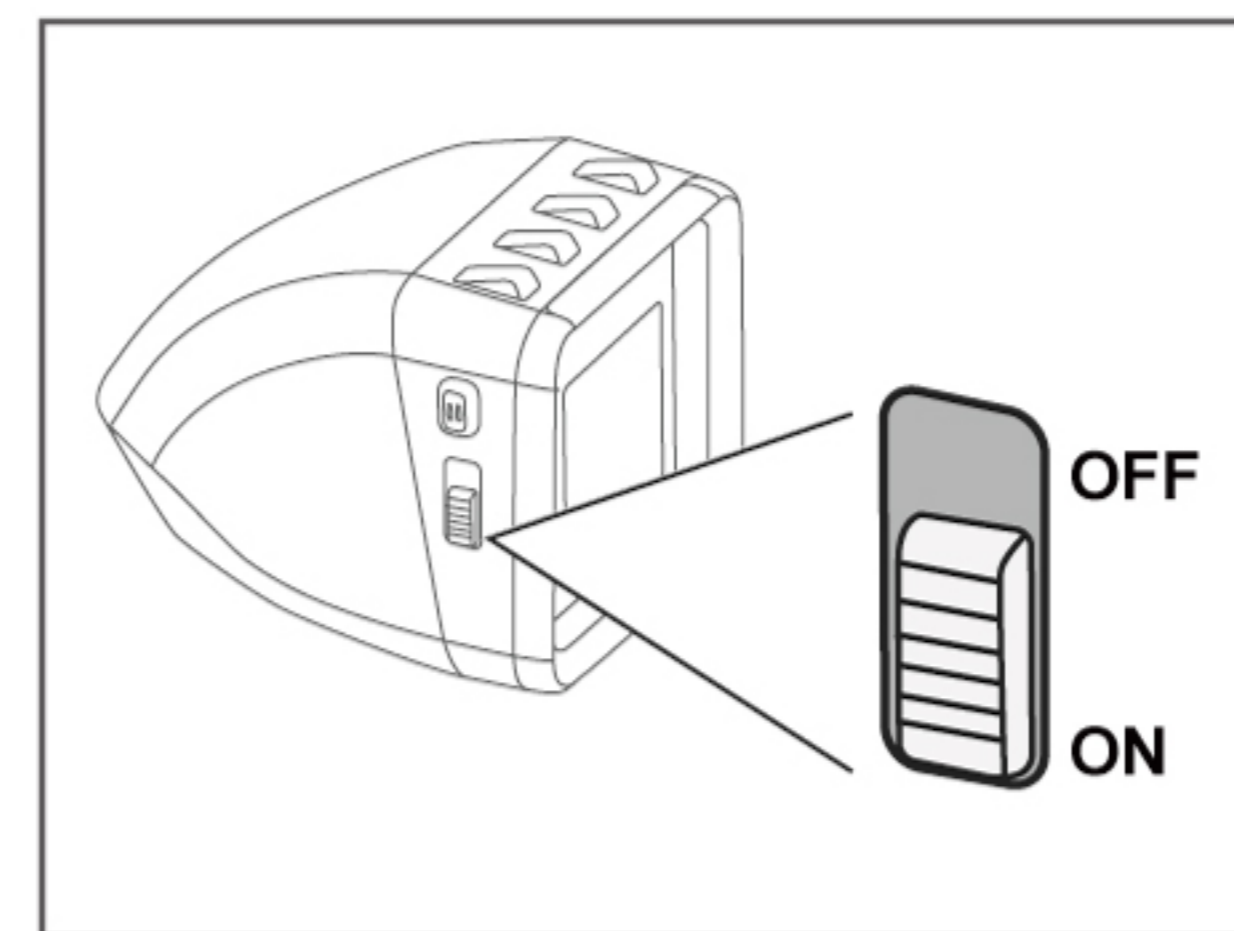

Step 5: Turn the car ignition switch to "ACC" position and ECO STAR will start simultaneously. (When the car ignition switch is turned to "OFF" position, ECO STAR will also be turned off.)

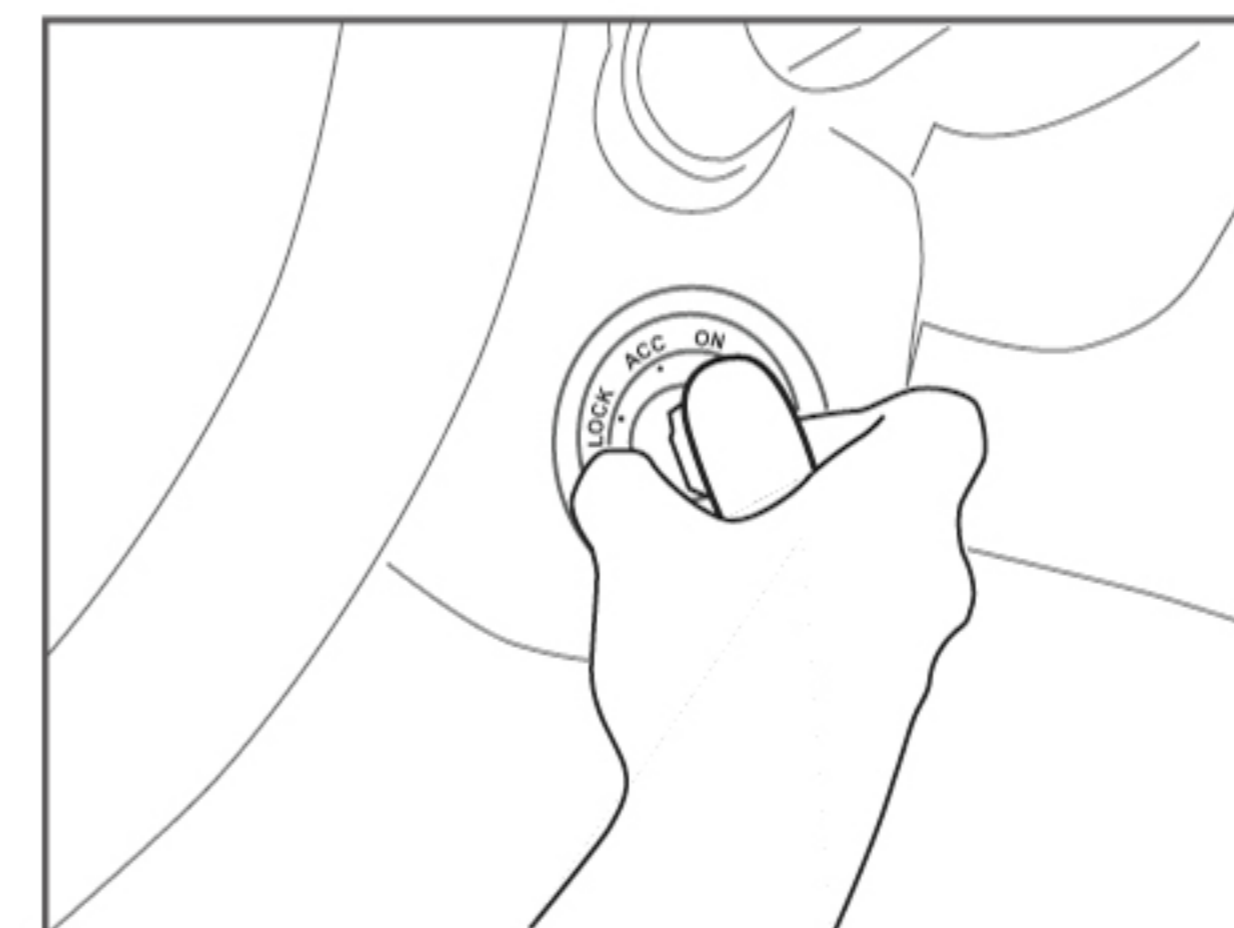

Step 6: To ensure accurate detection of your driving behavior, please do not move ECO STAR after being fixed on the anti-slip sticky pad.

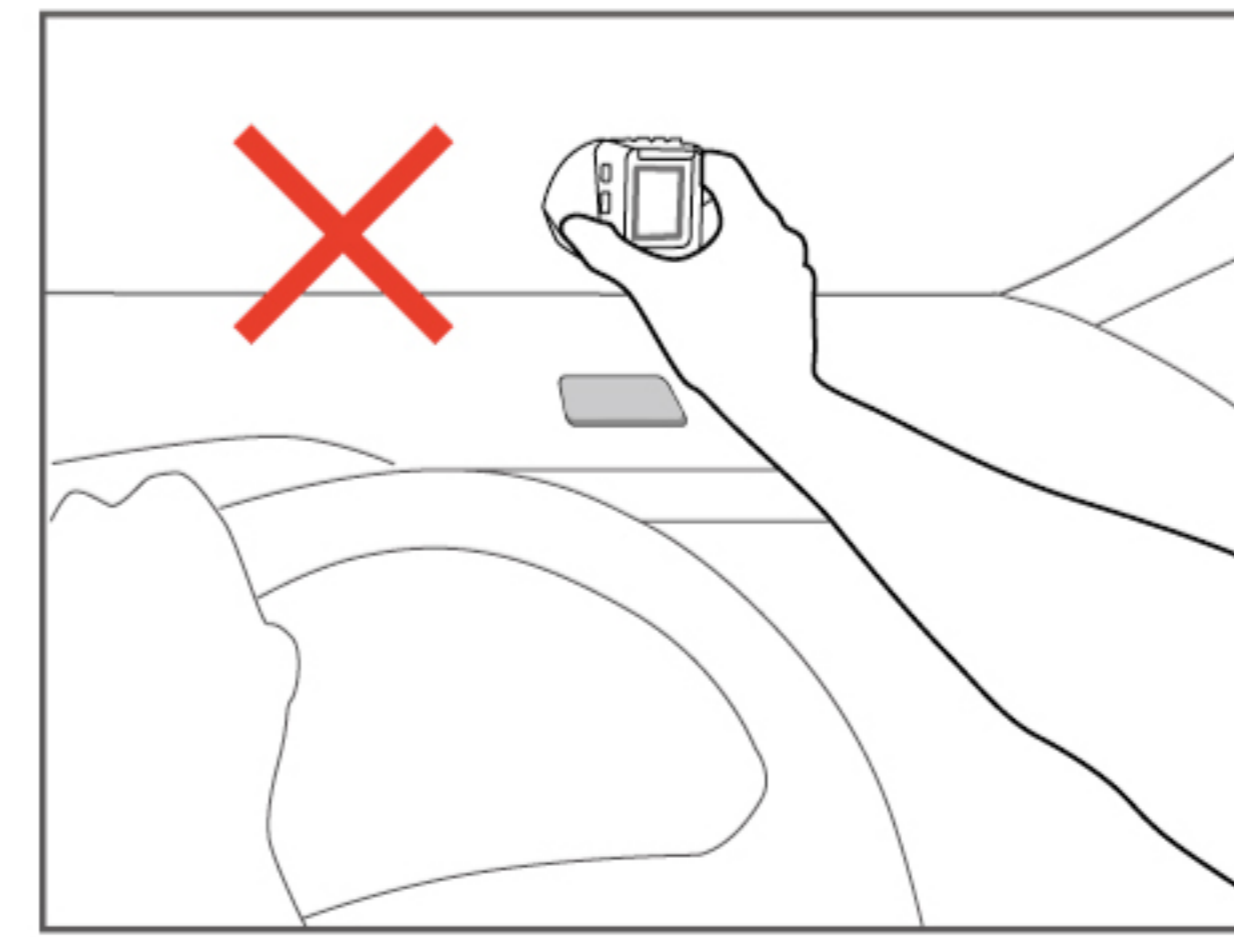

Step 7: ECO STAR has to be used outdoor in open-sky area. Tall building or trees may sometimes interfere with GPS reception.

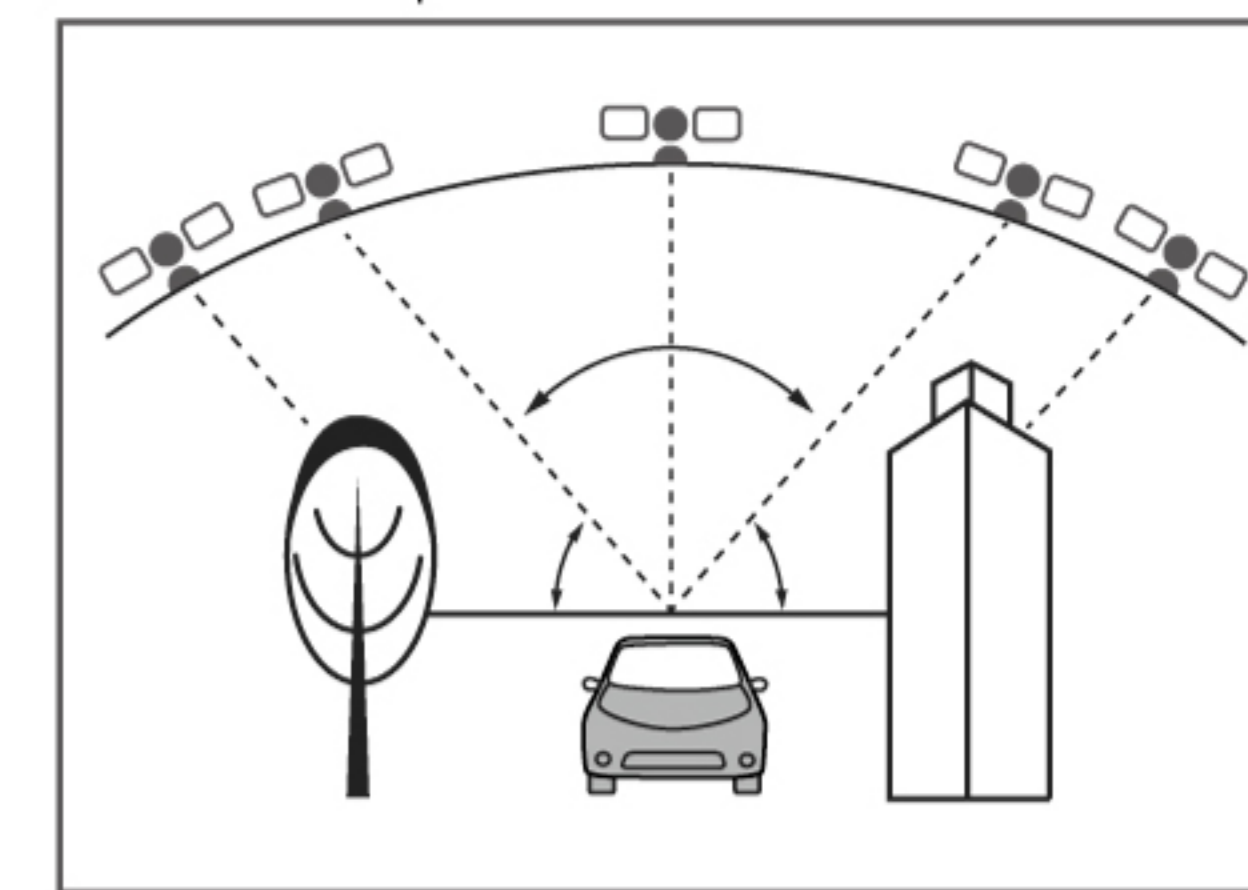

Step 8: For driving safety, do not operate ECO STAR while driving.

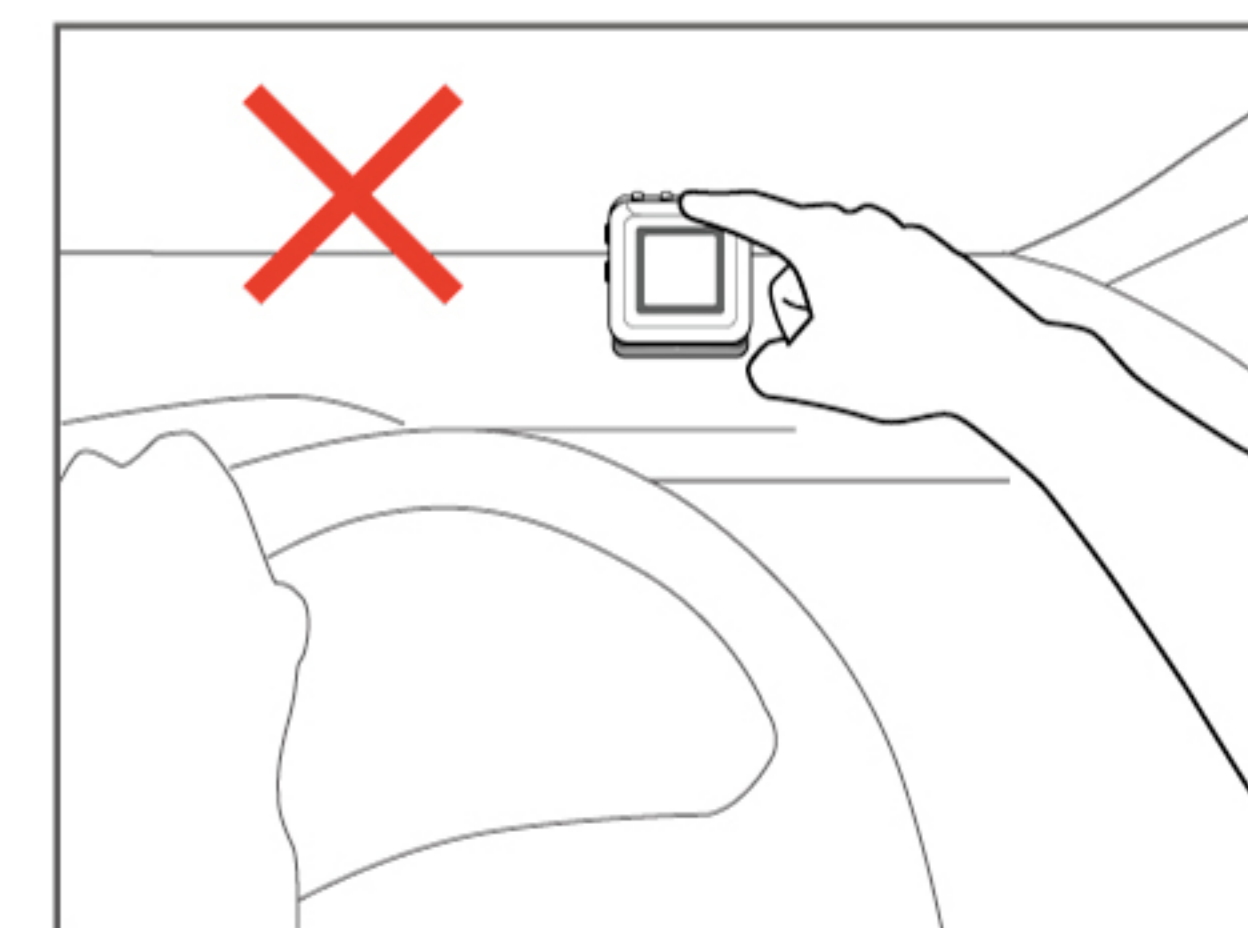

- **Tip:** Vehicle's speedometer is usually read 3~5mph faster than ECO STAR's GPS speed. It is designed slightly in excess of actual speeds to prevent speeding tickets. It is recommended that you follow your vehicle's speedometer to ensure you stay lower than the posted speed limit.
- **Tip:** To ensure accurate detection of your driving behavior, please firmly fix ECO STAR on the dashboard and do not move it before you turn on vehicle switch to "ACC" position.



<http://eco.qstarz.com>

QSTARZ

© 2013 Qstarz International Co., Ltd. All rights reserved.
Specification is subject to change without prior notice.

1. Product Safety Notice

Note: Please read this section carefully before using the ECO STAR

- When installing the device, make sure the ECO STAR logo on the top device face up to the sky for better GPS satellite signal.
- For precisely detect hazardous driving condition and fuel condition, please install the device correctly before start the car engine.
- For safety, do not operate the device while driving.
- Please note windows film may interfere and affect GPS signals.
- Keep the ECO STAR far from heat or high temperature environment. We recommend not to expose your ECO STAR in temperature higher than 145°F/60°C to prevent the device from overheating, exploding or melting itself.
- Do not expose this product to rain or moisture.
- For your safety, take care to route all cables away from shifters, pedals, accessory controls and mechanisms. Do not mount the devices in a place where the driver or passengers may receive injury during vehicle operation or collision.
- Do not attempt to open ECO STAR by yourself. Unauthorized hacking may damage the unit, and void your warranty.

2. Install ECO STAR

Select a flat surface on your vehicle dashboard, use anti-slip sticky pad to fix ECO STAR on the dashboard. Make sure ECO STAR is sticking parallel with the dashboard in order to precisely detect your driving behavior.

Plug car charger into cigarette lighter socket, and plug the other end into ECO STAR USB socket.

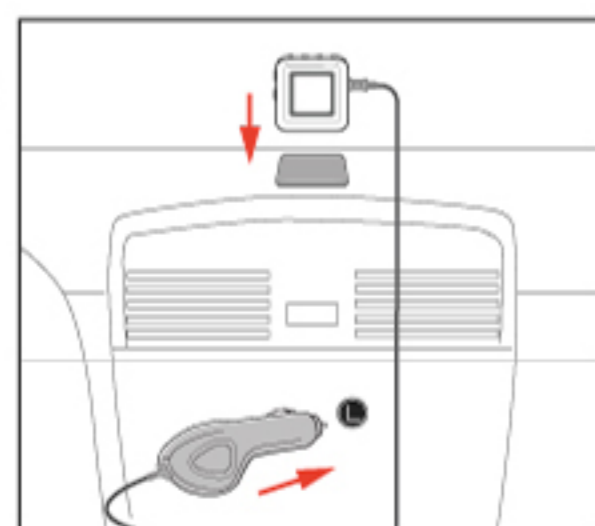

Note: The anti-slip pad won't leave sticky marks or color stains, and it is reusable and washable! When adhesive strength is getting weakened due to dust and soiled, it can be washed with water or soap to get the adhesive strength back.

3. Start to Use

3-1 Startup and Setting Preference

Please switch the power button to On for first-time use, and start the vehicle engine.

Note: ECO STAR can be only turned on with power supplied.

When Startup, ECO STAR will display various greetings randomly and seat belt reminder on the screen.



ECO STAR will prompt to display configuration menu for the first-time startup. After setting the language, Unit, Time Zone, Time format, select "Apply" to complete the first-time startup procedures and configuration. You can also manually adjust them in Setting mode later on.

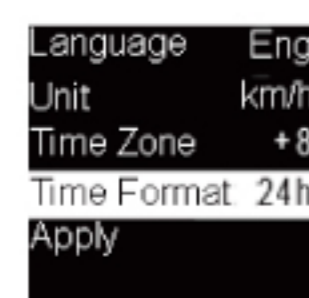

3-2 GPS Satellite reception

ECO STAR is built in GPS module which needs to be used outdoor or under open sky environment. Once power on device it will be automatically searching for satellite signals, it may take 30 seconds to 3 minutes to get satellites connected depending on the environment. When the right screen display, means ECO STAR is searching for GPS satellite signals.



3-3 Getting Started -Real-time driving status screen

Once connected with satellites, ECO STAR will start to show your real-time driving status. Real-time driving status is categorized with four types as below:

(1) Stable driving status: If the driving is smoothly, accelerating gently and avoid unnecessary braking, LED will light solid green indicating ECO and the screen will show right animation with day or night mode to advise that you are currently on stable driving status.



(2) Unstable driving status: When the driving is unstable, accelerating and braking sharply, ECO STAR will make a beep warning sound. LED will be flashing red then turning solid red indicating Non-ECO, the screen will show right animation to advise that you are currently on unstable driving status.



(3) Start Status: Depending on the stability of each time you start your vehicle, ECO STAR will advise you if it's a Good start or non-ECO start. Good start can help you to achieve the purpose of energy saving and driving safety.



Good Start screen: ECO STAR will make a beep sound; LED will light solid green for 3 sec. indicating ECO.



Non-ECO Start screen: ECO STAR will make a beep sound; LED will light solid red for 3 sec. indicating Non-ECO.

(4) Temporary stop screen: Once you stops, ECO Star will turn to display today fuel efficiency and real-time comparison status. When vehicle is temporarily stop(vehicle not yet reach the set idling time),the screen will display today fuel efficiency by tree. The more the number of trees appear, the higher fuel efficiency it is. At the same time dynamically advise whether your driving is getting better, stay unchanged or getting worse comparing with previous day-drive. This allows you to work and progress day by day to achieve safe and energy-efficient driving.

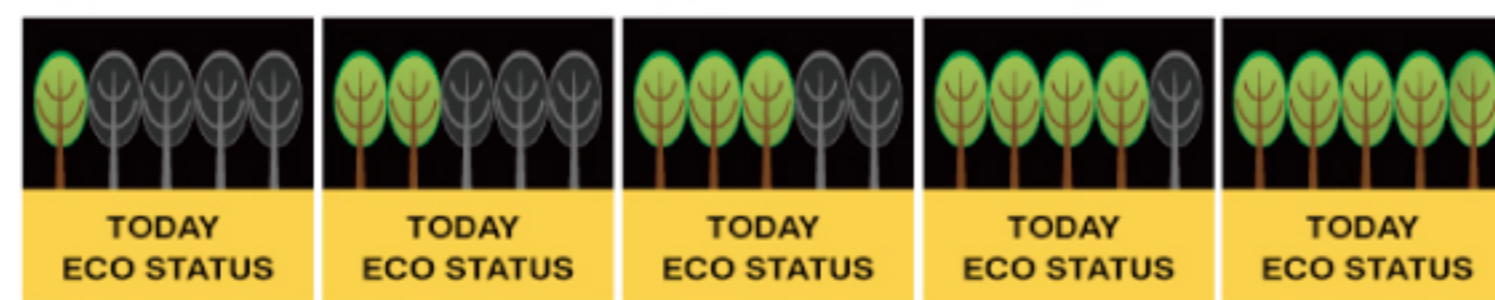

3-4 Alarm screen of dangerous driving

ECO STAR will alarm various dangerous driving warning according to your alarm setting. (You can enter setting mode to adjust the Alarm settings, as describe in 4-2)

(1) Over speed Alarm screen: Over speed alarm screen will appear when the speed exceeds the set speed condition. Red LED will light on and beep to warn driver you are speeding. Alarm will be continued until speed is lower than set speed.



(2) Acceleration alarm screen: The screen will appear when ECO STAR detects rapid acceleration, red LED will light on and beep to warn the driver. Alarm will be continued until acceleration is improved.



(3) Deceleration alarm screen: The screen will appear when ECO STAR detects hard braking; red LED will light on and beep to warn the driver. Alarm will be continued until deceleration is improved.



(4) Rapid right turn alarm screen: The screen will appear when ECO STAR detects sharp right turn, red LED will light on and beep to warn the driver. Alarm will be continued until rapid turn is improved.



(5) Rapid left turn alarm screen: The screen will appear when ECO STAR detects sharp left turn, red LED will light on and beep to warn the driver. Alarm will be continued until rapid turn is improved.



(6) Idle alarm screen: Idle warning screen will appear when ECO STAR detects the vehicle idling time exceeds set idling time, red LED will light on and beep to warn the driver. (Default idle time is 3 minutes)

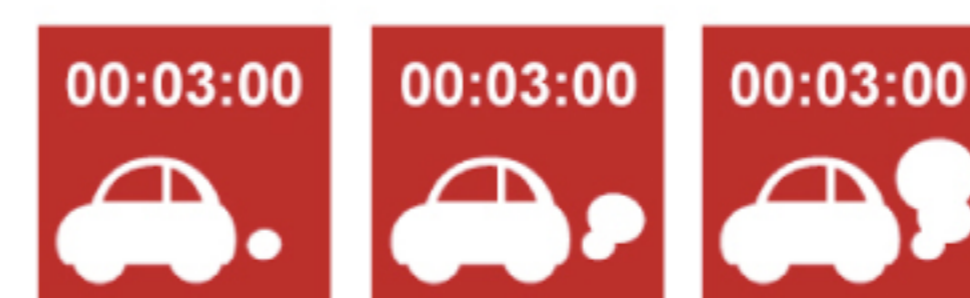

(7) Maintenance reminder screen: You can set the mileage for maintenance in Setting>>Alarm>>Maintenance. When reaching the set mileage, ECO STAR will show the maintenance reminder screen on your next startup the device.



4. Setting

For safety reason, ECO STAR is not allowed to setup the device while driving. The vehicle must be stopped in order to access the Setting mode. You can press Next or Previous button to enter Setting mode and press Enter button to begin. Select general or alarm setting accordingly.



4-1 General Setting

Select general setting and can adjust Languages, Distance unit, Time zone, Time format, Daylight saving time (DST), Sound, Backlight or Factory reset. Select Demo mode and can quickly understand the product operating screen. Select About can obtain product version and relevant information.

Note: Factory reset will erase all history data and restore all settings to factory settings.

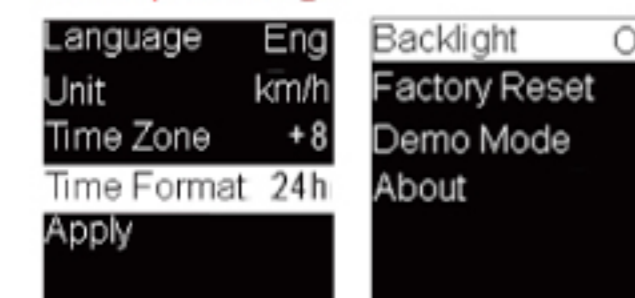

4-2 Alarm Setting:

Select Alarm setting and can adjust Over speed, Acceleration, Deceleration, Idle, Rapid turn and ECO start alarm condition. The default setting for over speed alarm is set to 110kph, idling time alarm is set to 3 minutes and ECO start alarm is set to On. Over speed and Idling alarm setting can be adjusted according to your country's traffic regulation. If you do not need ECO Start detection, it can be set Off.

Acceleration/Deceleration/Rapid turn alarm level are set to Medium by default (This is containing three level: Hard/Medium/Easy). If very few dangerous driving alarm screen/beep sound prompts, we are glad to tell you have a good driving habits. You can try to adjust each alarm level to Hard and learn to achieve better and higher safe and energy-saving driving. If the dangerous driving alarm screen/ beep sound frequently prompts, it is recommended that you adjust all the alarm level to Easy, it will allow you to improve driving habit step by step and learn a better safety and energy saving driver from the beginning level.

